



Starting in the Reception Class

**Starting in the Reception Class**

at  
**Warren Road Primary School**



[www.warrenroadprimary.co.uk](http://www.warrenroadprimary.co.uk)

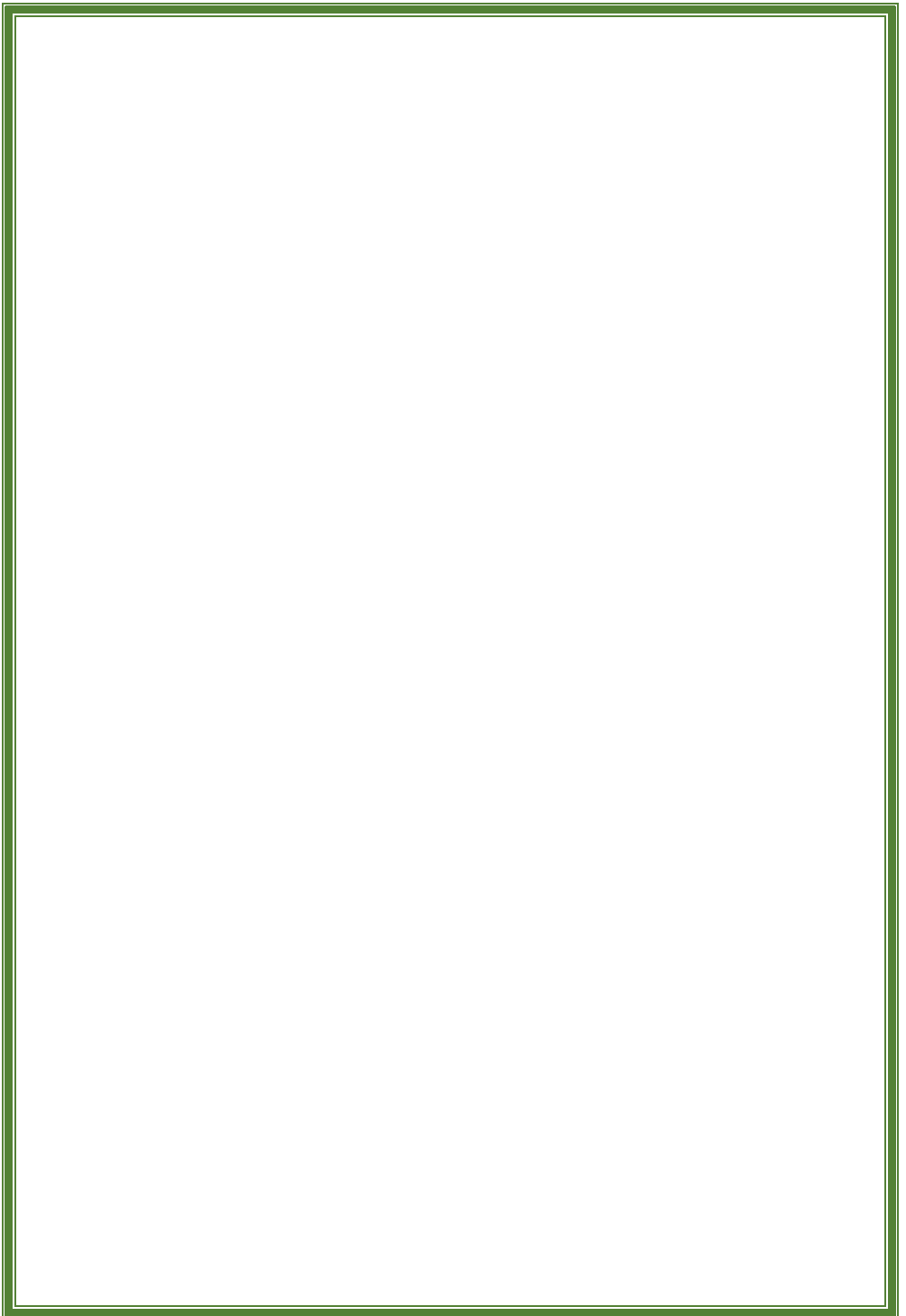

## **Welcome**

Welcome to Warren Road Primary School. Your child's welfare and well-being are of paramount importance to us. We operate an open door policy so, if you have any concerns about your child, please do not hesitate to contact us. We are here to help and support you and your child through the beginning of what we hope to be a very happy time at Warren Road.

## **Introduction**

This booklet is designed to help parents and carers of new reception children starting at Warren Road Primary School. It contains information covered in the introductory 'Parents Talk' and reference to it will ensure that your child makes a settled start at our school. If you have any further queries not answered by this booklet, please ask your child's class teacher, speak to Miss Waterman, Deputy Head or email us at [reception2021@warrenroad.bromley.sch.uk](mailto:reception2021@warrenroad.bromley.sch.uk)

Various school policies are available via  
<https://www.warrenroadprimary.co.uk/policies-and-data/>

## **Class Groupings**

Children start school in the September of the academic year when they turn 5 years old. Any parent who feels their child is not ready to start school, for example, if they are not yet toilet trained, should contact the Headteacher to discuss a longer phased entry. At Warren Road Primary School, the children will be grouped equally across the four Reception classes. The following plan of the school shows where these classes are situated in the reception building:

Warren Road



Reception Outside Area

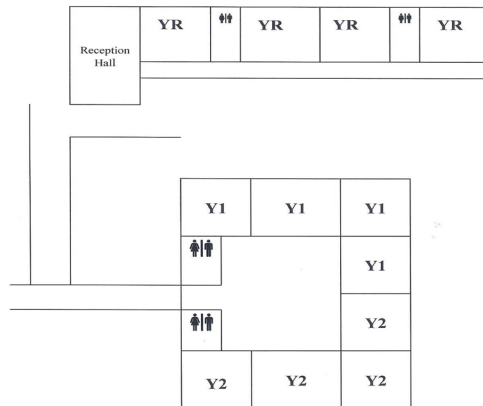

## Our Aims

Our aims are that your child will:

- Be happy and feel positive about school;
- Feel safe and secure in their new environment;
- Fit in well with peers and make friends;
- Develop confidence in relating to and cooperating with new children and adults;
- Be polite, kind and considerate towards others;
- Become more independent and self-confident about tackling new skills and activities;
- Develop good attention skills and the ability to concentrate on tasks;
- Develop their vocabulary and communication skills, feel confident to express their ideas and know that their ideas will be valued;
- Achieve their best in all areas of the curriculum and be proud of their achievements.

## **The Reception Curriculum**

The Early Years Foundation Stage Framework (EYFS) consists of three *prime* areas and four *specific* areas of learning and development. The prime areas cover the knowledge and skills which are the foundations for children's development and future progress, and which are applied and reinforced by the specific areas - particularly Literacy and Maths - they form an appropriate starting point for the Year 1 curriculum.

The Reception curriculum consists of;

### **The Prime Areas**

- Personal, Social and Emotional Development
- Physical Development
- Communication and Language

### **The Specific Areas**

- Literacy
- Mathematics
- Understanding the World
- Expressive Arts and Design

Further information regarding this can be viewed at;

[https://assets.publishing.service.gov.uk/government/uploads/system/uploads/attachment\\_data/file/974907/EYFS\\_framework\\_-\\_March\\_2021.pdf](https://assets.publishing.service.gov.uk/government/uploads/system/uploads/attachment_data/file/974907/EYFS_framework_-_March_2021.pdf)

## **Methods of Teaching and Learning**

***“Play is the work of childhood” Jean Piaget***

The EYFS curriculum is play-based, taking your child's

unique qualities into account. The children will have a lot of different learning opportunities and experiences which take place outside as well as within the classroom. The purpose of these will be to:

- Interest and motivate the children;
- Develop their feelings of security and confidence;
- Extend their vocabulary, and language skills;
- Develop their fine and gross motor skills;
- Develop their concentration and persistence;
- Develop their own thoughts and ideas;
- Encourage their personal interaction with their peers so that they quickly form friendships and settle into their new environment.

Young children have diverse interests and fascinations which we try to incorporate into their learning. Interests, such as superheroes, explorers, or even trains, will be added to by learning about various celebrations, appropriate and relevant current events, world sports, or focus charities, to name a few.

## **Our Induction Programme**

Although your child may have attended a pre-school playgroup or nursery, there will be many changes for them to cope with when they start school, including:

- Becoming familiar with a new, large environment;
- Mixing with large numbers of children at lunchtime and in the playground;
- Having to share their teacher with a large number of children;
- Meeting and recognising many new adults, such as teachers, teaching assistants and midday supervisors, as well as many new children;
- Following a timetable which may sometimes put constraints on their movements and choice of

activities;

- Coping with new experiences and routines and getting used to a longer, more tiring day.

To ease the children into these new changes we have planned a gradual introduction to the full school day.

## **Pre-school Visits**

Your child will have two pre-school visits prior to starting school, as follows:

- **1<sup>st</sup> Visit – Meet the Teacher**

You accompany your child and play together with the games and equipment set up in the classroom. This enables you and your child to meet the teacher together in a relaxed and secure situation.

- **2<sup>nd</sup> Visit – Storytime**

You leave your child with the teacher so that all the new children can experience being together and being taught as a class for the first time. Parents will have the opportunity to socialise together while waiting.

## **Starting School**

In September our **School Induction Programme** will be phased in order to accommodate and settle the large number of children starting in September. We will be running with four classes of up to thirty children in each.

### **Week 1**

During the first week of term we will be holding 20-minute ***Parent and Child Meetings***. You will need to sign up for an appointment time for you and your child to come into school to chat to your child's class teacher. Separate details of how to do this will follow.

## **Week 2**

### **1<sup>st</sup> Day**

**From 9.00am to 1.00 pm (including lunch) –**

Please bring your child onto the Reception Playground where you will be greeted by staff. The first morning will be a soft start with plenty of time to take photos and celebrate your child's start to school. Once you have said goodbye you send your child in via their classroom door. You then come back at 1.00pm to collect your child from the same classroom door.

Remember to bring your child's lunch bag if they are having a packed lunch!

### **Subsequent days**

**9.00am to 1.00pm (including lunch) –** When your child's teacher opens the classroom's external door at 9am on the Reception playground, your child should go straight in with the teacher. Then you return at 1.00pm to collect him/her from the classroom, via the same door.

## **Week 3**

**From 9.00 am to 3.20 pm -** From now on your child will attend school for the full day. Please be prompt in collecting your child. If you should happen to be late in collecting your child, he/she will be taken to the main office and remain there until you arrive. A quick phone call to the office helps us to reassure your child that you are on your way.

You are very welcome to talk to the teacher about your child at the end of a school day. If you require a longer, more formal or private meeting, please make an appointment at a mutually agreed time. Please note that on Tuesdays and Thursdays there are staff meetings



starting at 3:45pm so teacher's time on these occasions is limited.

## **Settling in to school**

Starting school is an enormous step for a child to take and some children will have no problem adapting to school life whilst others will need lots of reassurance. Should your child cry, try to stay calm even though you are feeling as upset as he/she is. Make a firm exit, leave with a wave and a smile. Teachers and Teaching Assistants are used to dealing with children in this situation and will be able to calm and comfort your child after you leave. Be reassured that we will contact you if your child does not settle quickly.

There are times in your child's school life where he/she may feel worried or anxious because of circumstances outside of the control of school; it may be the arrival of a new baby or a house move. It would help us to be aware and sympathetic to your child's difficulties if you could let us know of these circumstances. We wish to help your child in every way possible.

## **Attendance and Punctuality**

If your child is ill, or absent for any other reason, please inform the school office as early as possible on a daily basis. If your child has sickness or diarrhoea, they will need to be absent from school for at least 48 hours after the last bout of illness to ensure they are not contagious.

It is very important that the school office has at least **3 emergency contact numbers** in case your child is unwell whilst they are at school. Please ensure that you contact the office to update them if there are changes.

The school is unable to authorise absence for holidays,

except under exceptional circumstances agreed by the Headteacher.

***Punctuality and attendance are important to both your child's education and social wellbeing.***

	Morning Registration	End of day
Reception	9 am	3:20pm
KS1 (Years 1 & 2)	8:45 am (children can come into class from 8:45-8:55)	3:20pm
KS2 (Years 3 - 6)	8:45 am (children can come into class from 8:45-8:55)	3:30pm

## **School timings**

### **Travel to School**

As an Eco School we promote sustainable ways of travelling to and from school. Children are encouraged to walk to school as often as possible.

Scooter racks and a bike shed are also provided but children should not scoot or cycle once they are inside the school gates. If you bring your child to school by car, you may wish to 'park and stride', i.e. park 10 minutes' walk away from the school. When parking near the school gates, please be considerate towards our neighbours and **help ensure the safety of our children by not parking on zig zag lines.**

### **Playground Reminders**

- Please ensure that all children who are waiting with you on the playground are carefully supervised and

- do not use the equipment left out.
- It is helpful if you can wait away from the classroom windows when collecting your child from school so that story time or other class activities can be free from outside distractions.
  - Children should not ride bikes or use a scooter in the school grounds at any time.

## Lunch Arrangements

You child will eat in the hall with the other Reception children and a midday meal supervisor will be with them all the time.

The lunch break for Reception pupils is from 11.50am to 1.00 pm. Your child has the choice of:

- Eating a school dinner – Every child starting school in Reception will be entitled to have a free school meal. Further information will be provided in September regarding this. Independent Caterers will supply a menu which will be emailed to you so that you can discuss the choices with your child each morning.
- Bringing a packed lunch – This can be in a **named** box/bag with an ice pack enclosed in hot weather. We are a NUT and SESAME SEED FREE school (including nut based chocolate spread). *Please do not include ANY **nut products** in your child's packed lunch as several children in school suffer from severe nut allergies.*
- We are a 'Healthy School' and encourage all children to eat well. Please ensure no chocolate, sweets or fizzy drinks are put in lunchboxes.
- Going home for lunch- in this case your child should be collected by an adult from school at 11.50 and returned by 1.00 pm.

## Playtimes

- Drinks – your child must bring water in a **named** refillable flask or plastic bottle to have throughout the day. We have drinking water taps in the classrooms when refills are needed.
- Snacks – your child will be offered a piece of fruit to eat during the morning, as part of the government's scheme providing free fruit to infants, but *no sweets, biscuits or crisps are allowed*. The school operates a 'healthy eating' policy.
- Accidents – if your child has a fall resulting in a minor cut, bump or graze he/she will be cleaned up by a member of staff and kept in school. Teachers will inform you of any bumps to the head because of the possibility of delayed concussion. Children wear stickers to inform others of their head injury. You will be notified of any serious injuries by telephone so that your child can be collected and given any necessary medical treatment. *Please ensure that we have up to date emergency telephone numbers for contacting you in the event of your child being ill or having an accident.*

## Things you will need

- Uniform – (see list in starter pack and school website) Can be purchased from Graduates School Shop in Orpington High Street or from our PTA Nearly New Uniform shed.
- Waterproof coat each day
- Wellington boots (these will stay in school)
- Book bag
- PE kit
- Water bottle

**Please ensure all items are labelled with your child's name.**

The Parent Teacher Association regularly holds sales of 'nearly new' uniform.

Please practise doing up shoes, buttons and zips with your child at home so that they can become independent at dressing/undressing in school. Velcro fastenings on shoes aid independence.

Jewellery - The wearing of jewellery is not permitted, with the exception of ear studs. It can be dangerous, particularly in PE lessons, both to the wearer and other children. If ear studs are worn they must be removed before coming to school or taped over for PE lessons. Please provide tape for the class teacher to do this.

Toileting – Your child should be able to manage to go to the toilet without help. If a child has an 'accident' in school, they are given spare clothes to change into. We appreciate it if these clothes are washed and returned to school within the following few days.

## **Communication**

Our primary forms of communication with parents are via email from the school office and Class Dojo for more informal messages and opportunities to share day to day activities that your child is taking part in. Further information will be sent out in the Autumn Term.

## **Home Learning**

Your child's learning and progress is achieved most effectively when supported at home as well as in school. Your child will have the opportunity to engage in

homework tasks over each term. Reading books will be sent home each week. You will receive a reading record book for teacher and parental comments. Please provide a named book bag for your child.

### Reading together

It is important that you read the books together in a quiet and relaxed atmosphere and that you choose a time that is suitable for you both. Do not drag your child away from his or her favourite TV programme! Make sure that you are both sitting comfortably and try not to have any distractions. Do not make the session too long (10 minutes a day is perfect) and if your child is tired or loses interest then it is better to stop and choose another time.

- Make sure that your child can see the words and pictures.
- Look at the pictures and talk about what can be seen in them.
- Always allow plenty of time to talk about the story and ask questions such as 'What do you think will happen next?'
- If your child is reading to you and they are stuck on a word, encourage him/her to guess the word from the context of the story, the picture or from the first letter.
- If this fails, tell him/her the word.
- Always give plenty of praise and always make reading together an enjoyable time.

Remember, even when your child can read it is important that you continue to read to them and share stories together.

Throughout the year, we will send home lists of words which should be practised on a regular basis at home.

We love to receive updates about your child's achievements at home. We will inform you how to do this once your child has settled into school.

### **Celebration Assembly**

Each week we hold a 'Celebration Assembly' when we celebrate the birthdays and achievements that have occurred that week.

### **Taking an interest**

The school day is very busy and your child will be involved in various activities during that time. However, don't be surprised if your child comes home reluctant to tell you what he/she has been doing. Usually the answer to your questions will be 'nothing much' or 'just playing'. Keep showing an interest and you will get all the news as soon as he/she is ready.

Should you hear something about school that worries you when you are talking to your child please do come and talk to us. Children often relay events from their own point of view and facts can be distorted.

Please try not to compare your child with another. Your child is unique and will do things his or her own way. A child will grow in confidence and learn successfully if he/she knows that you are proud of them and praise is given for minor as well as major achievements.

### **Children with Special Education Needs**

We see every child as special with differing needs. Some children might need to be given more support than

others. If we feel that your child would benefit from a special programme of support, we will contact you before embarking on the programme. Children may of course have been identified as having needs in their preschool, for example speech and language therapy, and we will discuss opportunities for this with you as your child starts school. If you have any information regarding support your child has already had eg. Speech Therapy, please let Mrs Read (SENCO) know as soon as possible.

## **Helping your child to cope**

Six hours a day at school is long for any child, but the youngest children might feel this the most. To ensure that they have the stamina, let them rest when they come home and make sure their weekday bedtimes are early. This holds true throughout the whole of their school life.

## **Warren Road PTA**

The Parent Teacher Association (PTA) raise funds through popular events for facilities and equipment that would not otherwise be provided e.g. wet play toys, sports kit. As a parent or carer of a child at Warren Road, you are automatically a member of the PTA and they are always looking for new committee members and volunteers to help at events. New ideas and skills to help raise funds are particularly welcome!

## **Toys**

Please could we ask you to help us by ensuring that your child does not bring toys to school other than what they have been asked to by their teacher. I am sure you will appreciate the social problems they might cause. The



school cannot accept responsibility for toys and other valuables, which are brought to school.

## **Parental Help**

Once your child is settled into school we welcome parental help. Any parent wishing to assist must successfully complete an enhanced Disclosure and Barring Service (DBS) check. Please speak to your child's class teacher about this possibility.

***We will do our best to ensure that your child has a happy and positive start to school life. If he/she does appear to be unhappy about anything to do with school please discuss this with the class teacher, or with another relevant member of staff, so that problems can be sorted out quickly.***

***We look forward to your child joining us at Warren Road Primary School.***

## **NOTES**